

# Galintel® J-Bar\*

## Steel Shelf Beam



### GALINTEL® J-BAR\* SHELF BEAM

The Galintel® J-Bar\* Shelf Beam is the ideal solution for cavity walls, either double brick, or brick veneer with timber trusses.

The J-Bar\* was developed in response to demand from builders for an economical substitute for built-up steel sections such as parallel flange channel and plate.

Similar to a T-bar but with a special top flange incorporated into the upright section, the Galintel® J-Bar\* provides an off-the shelf solution for cavity walls and is hot-dip galvanised, fully engineered and university tested.

Available from accredited Galintel® distributors, the J-Bar\* is a convenient alternative to custom-made beams such as PFC and flat plate, which have to be fabricated and galvanised.

As with all quality Galintel® products, the J-Bar\* Shelf Beam is provided with a full product warranty and safe load tables.

**The Galintel® brand is your guarantee of quality, performance and code compliance. For full technical details, phone 1800 065 634 or email [bi@nepean.com.au](mailto:bi@nepean.com.au)**

#### The quick, economical solution for cavity walls

- > Header flange pre-drilled & galvanised for timber fixing
- > Bottom flange pre-drilled & galvanised for column connection
- > Innovative, efficient design
- > Up to 20% lighter than built-up steel sections
- > Fully hot-dip galvanised including ends (600 g/m<sup>2</sup>)
- > Standard range of lengths
- > Non-standard lengths available to order
- > Engineered and university tested
- > 25 year performance warranty
- > Convenient 'off the shelf' solution
- > R3 durability rating

\*Registered design

# J-Bar Applications

## Typical J-Bar Applications

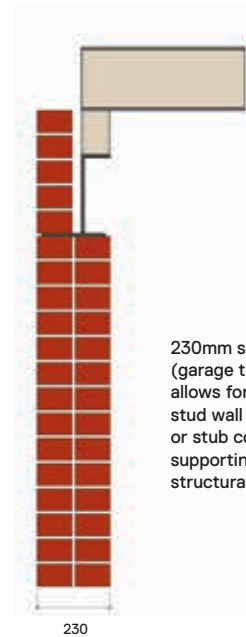
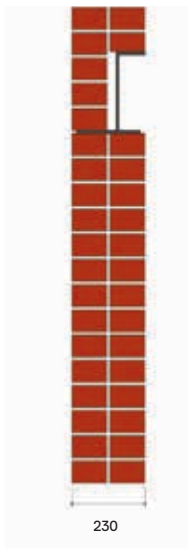
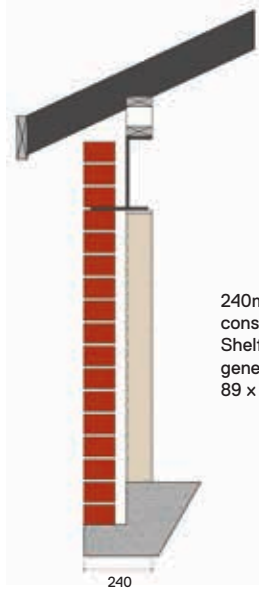

## Galintel® J-Bar Safe Load Table

Vertical Leg 260 x 90 Platform Leg 200 x 10 Mass 45 kg/m (Hot Dip Galvanized Finish)

Span (mm)	3900	4200	4500	4800	5100	5400	5700	6000
Bar Length (mm)	4200	4500	4800	5100	5400	5700	6000	6300
UDL (kg/m)	2895	2370	1865	1370	1210	1080	865	740
Point Load (kg)	7065	6130	5230	4330	3990	3690	3170	2850

Loads limited by deflection of 1/500 span

### Notes on Safe Load Table for J-Bars

This load table assumes that:

- > The web of the J-Bar is vertical
- > The J-Bar is simply supported at both ends
- > The J-Bar is loaded such that the load acts vertically and equally on both sides of the web
- > The J-Bar is considered as being laterally unrestrained for the full span length
- > UDL loads are constant along the length of the bar
- > Point loads are assumed to act at midspan
- > 150mm minimum end bearing support onto brickwork
- > Hot-dip galvanised to AS/NZS4680:2006
- > Loads in accordance with AS/NZS1170.1:2002

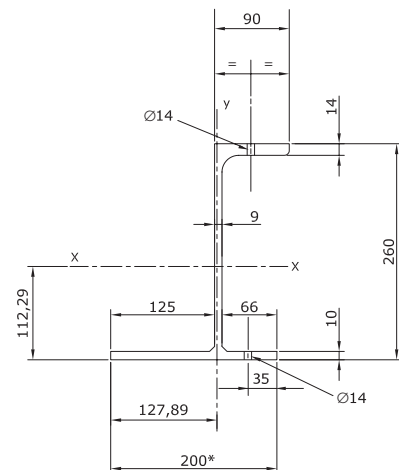

\*Platform leg available in 300mm width. (Section details and load tables available on request)

Information contained in this brochure is supplied in good faith and with a view to help the user in the correct installation of this product. While every care is taken to ensure the information is correct, no warranty is made nor is any condition expressed or implied. The information contained herein does not constitute an offer nor do we guarantee its accuracy or completeness and assume no responsibility for errors or omissions or for any consequences of reliance on this publication. © NEPEAN, July 2013

For more information please contact:

#### HEAD OFFICE

117-153 Rookwood Road  
(PO Box 57)  
Yagoona, NSW, 2199, Australia  
P: + 61 2 9707 5000  
F: + 61 2 9790 6145  
E: bi@nepean.com

#### BRANCHES

**NSW (COFFS HARBOUR)**  
47 Wingara Drive  
(PO Box 396)  
Coffs Harbour, NSW, 2450, Australia  
P: + 61 2 6652 4100  
F: + 61 2 6652 2285  
E: coffs.bi@nepean.com

**QLD**  
967 Nudgee Road  
(PO Box 283)  
Banyo, QLD, 4014, Australia  
P: + 61 7 3633 1333  
F: + 61 7 3633 1313  
E: qld.bi@nepean.com

**WA**  
98 Campbell Street  
Belmont, WA, 6104, Australia  
(PO Box 267,  
Cloverdale WA 6985)  
P: + 61 8 9478 1034  
F: + 61 8 9277 7742  
E: wa.bi@nepean.com

**VIC**  
171 Derrimut Drive  
Derrimut, VIC, 3030, Australia  
P: + 61 3 9394 1001  
F: + 61 3 9394 1441  
E: vic.bi@nepean.com